

PRODUCT TRAINING CARD



BAREMED®

Name:

Baremed

Description:

Urine Control Band

Field of Use:

The product is developed for Urology Services.

It is used in prostatitis patients who cannot control urine (involuntary leakage or drops) to prevent urinary incontinence.

The product is designed for adult male patients.

Function:

When the band is wrapped around the penis, the silicone strips located on the mid-section of the band surface that contacts the skin correspond to the urethra and act as barriers to apply physical pressure on it and prevent urine flow (passage).

Technical Specifications:

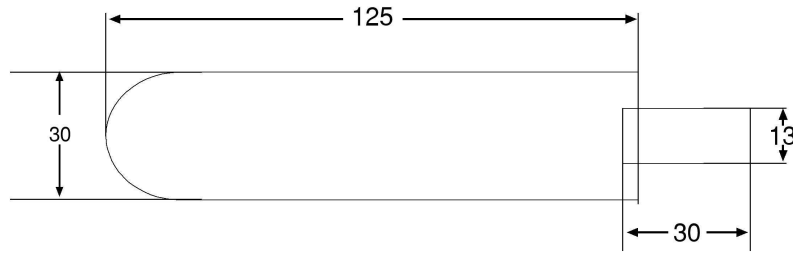

		
ÜRÜN ADI	BAREMED İdrar Engelleme Bandı	
ÜRÜN KODU	UCB 6001	
ÖLÇEK	1/1	BİRİM mm

FR.00.001

REV.01

The band is a short strip.

On its one side, the band comprises an elastic strip with Velcro* stitched on one end. This elastic strip is fixed with Velcro after it is wrapped around the penis and prevents the band from slipping off the penis. It also ensures that during wrapping pressure is applied onto the “silicone barrier” block which corresponds to the underside of the penis.

The band consists of 3 laminated** layers.

The outermost layer is made of napped** (raised) fabric. These naps ensure that the velcro fastening parts provide a secure hold. In the mid-section a foam layer is provided that adds the bandage softness.

The innermost layer of the band which comes into contact with the skin is made of Tyvek**** fabric which is anti-allergic and antifungal.

On the mid-section of the Tyvek surface which is in contact with the skin, 4 strips which are made of silicone rows adhered in parallel to each other are located which act as “barriers” against the urine flow.

The product is for single use and sterilized by means of Gamma Rays.

(**Velcro***: A special kind of fabric used instead of snap fasteners or buttons which contains micro hooks and adhere to fuzzy surfaces by means of said micro hooks.)

(Lamination:** A process of bringing different materials into a single piece by adhering them together under heat or using adhesive materials by means of particular methods and apparatus.)

(Napping*:** A process for raising the surfaces of combed cotton, cotton or synthetic fabrics through a special method; Napped fabric is a fabric rendered soft and velvety or fuzzy by raising one of its surfaces.)

(Tyvek fabric**** A anti-static, anti-bacterial and anti-fungal fabric invented and patented by Du Pont)

(Silicone***:** A polymer material in liquid, resin or elastic form comprising silicium and oxygen atoms. The variant used by Medikokim is an anti-carcinogenic and ante-allergic one which initially exhibits fluid characteristics and becomes solid but elastic with heat.)

Model / Code / Measurements

A single model is offered.

Code: UCB 6001

The product is 10 cm long, 3cm wide and 0.4 cm thick.

Use:

The band is oriented for daily use to be applied to a penis manually or with the help of an apparatus in order to apply pressure on the urinary canal without physically intervening with the penis.

In order to achieve this, the band is wrapped around the non-erected penis body in such a manner that it is gently tight and the barrier section is located beneath, i.e. on the urethra and then fixed by means of Velcro.

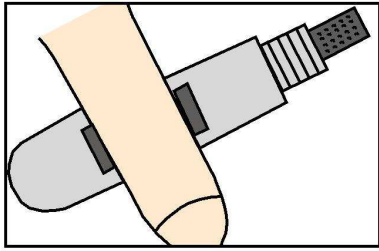

Place the silicone support under the penis

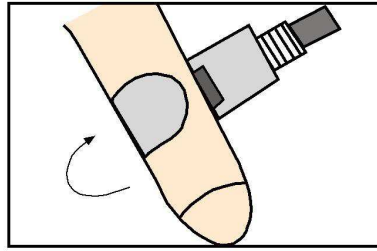

Wrap the oval tip around the penis

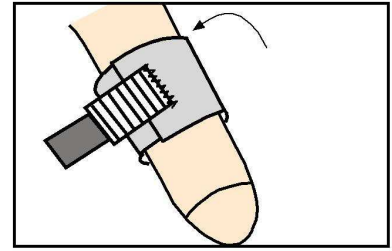

Put the straight end onto the oval tip

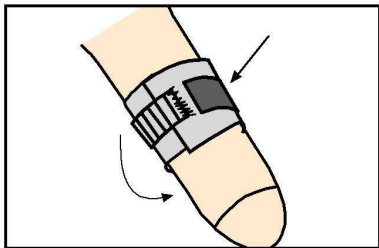

Stretching the elastic strap close the velcro. Do not overtighten



Pay attention for not to hinder the blood circulation

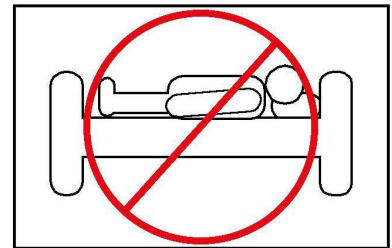

Do not use during sleep



*Bant prevents urinating and dripping
Do not accumulate your urine using band
When feeling, discharge your urine system at once*

Caution:

When fixing, it should be ensured that the band is not too tight so that it does not adversely affect blood circulation.

The band should not be used while sleeping.

The band should not be used permanently, but be removed periodically to allow urination.

The band is for single use only and should be replaced when worn out.

Packaging:

Each bag contains one product and is available in boxes of 25.